



USA9291

USA92911LF



THE BOSTON VALVE Co.

A DIVISION OF BOSTON METAL PRODUCTS, LTD.

25 THURBER BLVD., UNIT #3
SMITHFIELD, RI 02917

TOLL FREE: 1-800-839-0013, TEL: 401-231-8537
FAX: 401-231-8491

WWW.BOSTONVALVE.COM

USA9291 & USA9291LF SERIES

SOLDER BY FEMALE NPT ENDS

A forged brass quarter turn valve, 600 WOG/150 WSP rated, two piece, full port, with solder joint body and NPT end piece.

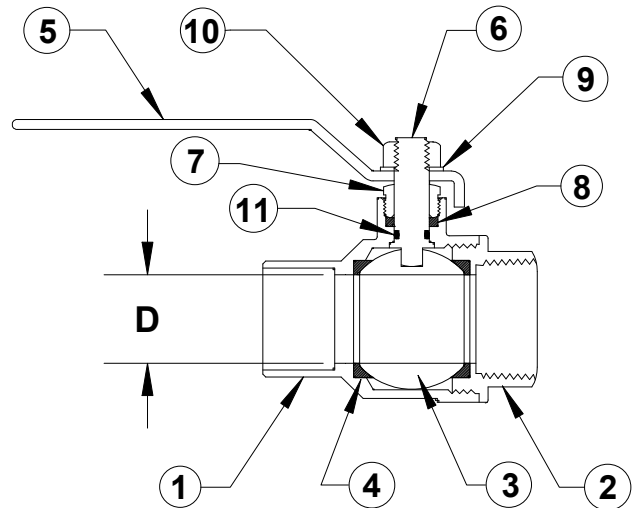
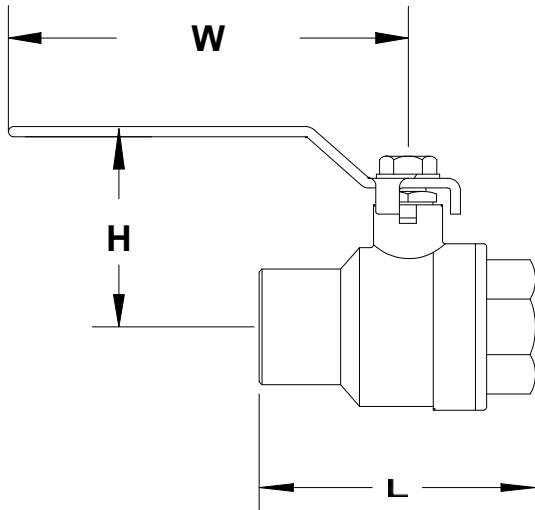

DIMENSIONS

CAT. NO.	CAT. NO.	SIZE	L	D	H	W
USA0509291	USA0509291LF	1/2	2.14	.59	1.77	3.65
USA0759291	USA0759291LF	3/4	2.54	.75	2.05	4.65
USA1009291	USA1009291LF	1	3.00	1.00	2.14	4.65

PRESS. VS. TEMP. CURVE

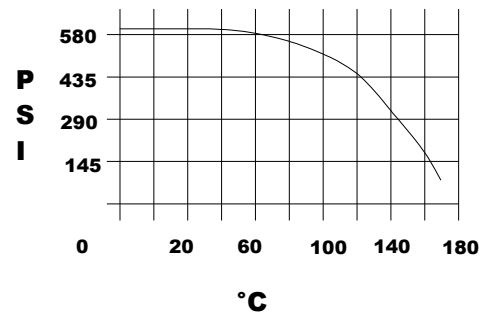

MATERIAL LIST

NO.	PART NAME	USA9291 SERIES MATERIAL	USA9291 SERIES MATERIAL
11	O-RING	BUNA-N	BUNA-N
10	NUT	STEEL, ZINC PLATED	STEEL, ZINC PLATED
9	LOCK WASHER	STEEL, ZINC PLATED	STEEL, ZINC PLATED
8	STEM PACKING	PTFE	PTFE
7	GLAND NUT	BRASS	BRASS
6	STEM	BRASS	BRASS
5	HANDLE	ZINC PLATED STEEL, PLASTICOATED	ZINC PLATED STEEL, PLASTICOATED
4	SEAT	PTFE	PTFE
3	BALL	BRASS, HARD CHROME PLATED	BRASS, HARD CHROME PLATED
2	END CAP	BRASS	BRASS
1	BODY	BRASS	BRASS

BOSTON METAL PRODUCTS, LTD. - 25 THURBER BLVD., UNIT #3 - SMITHFIELD, RI 02917
 TOLL FREE: 1-800-839-0013, TEL: 401-231-8537, FAX: 401-231-8491
 WWW.BOSTONVALVE.COM