

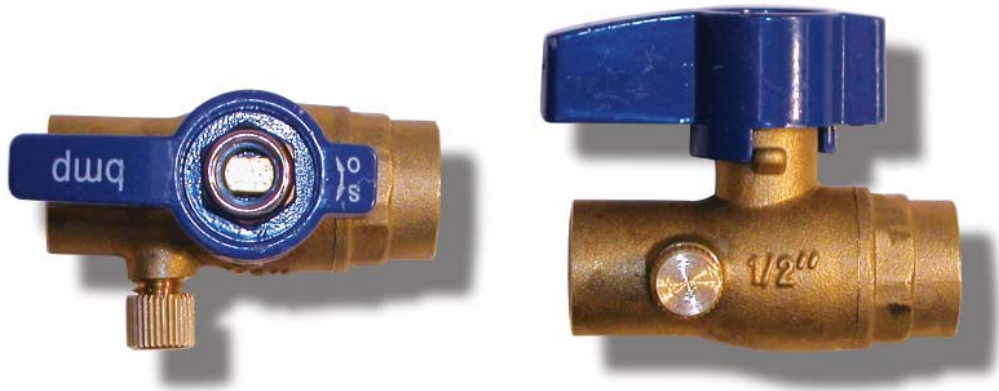

STW0002LF



THE BOSTON VALVE Co.

A DIVISION OF BOSTON METAL PRODUCTS, LTD.
25 THURBER BLVD., UNIT #3
SMITHFIELD, RI 02917

TOLL FREE: 1-800-839-0013, TEL: 401-231-8537
FAX: 401-231-8491
WWW.BOSTONVALVE.COM

STW0002LF SERIES

STOP & WASTE VALVE

A quality quarter turn brass valve with solder joint ends, aluminum wing style T handle, and double O-ring stem seal

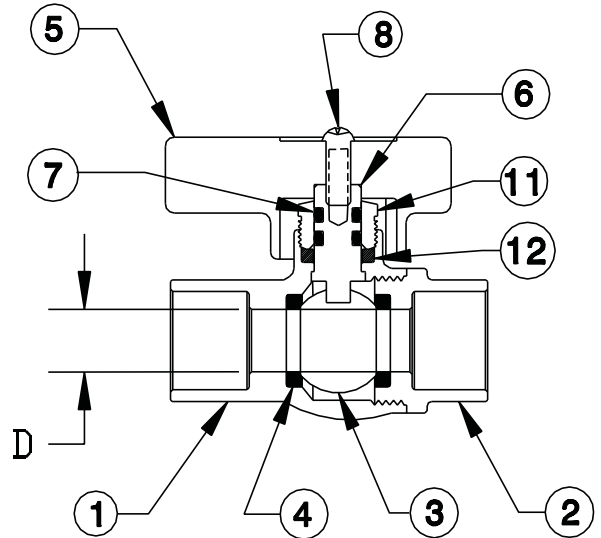
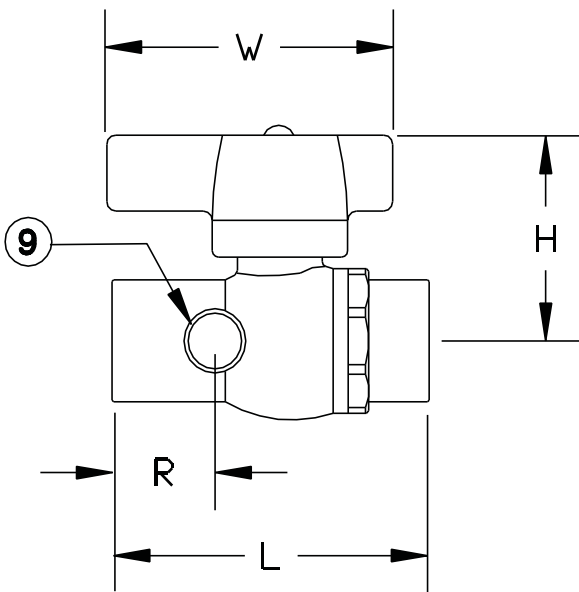

DIMENSIONS

CAT. NO.	SIZE	L	D	H	R	W
STW0500002LF	1/2"	2.10	.38	1.72	.65	1.15
STW0750002LF	3/4"	2.63	.51	1.53	.84	1.15

MATERIALS

NO.	PART NAME	MATERIALS
12	PACKING	PTFE
11	GLAND NUT	BRASS
10	DRAIN CAP SEAL	BUNA
9	DRAIN CAP	BRASS
8	SCREW	STEEL
7	O-RING	BUNA
6	STEM	BRASS
5	HANDLE	ALUMINUM
4	SEAT	PTFE
3	BALL	BRASS, CHROME PLATED
2	END CAP	BRASS
1	BODY	BRASS